



Thank you for choosing to decorate with Party Time Mysteries party printables ! We are delighted to be able to offer you an easy and affordable way to host an elegant and fun party.

Please read this page as it contains very important information about this printable package.

Fonts and editable text

There is no need to download any fonts to use with this pdf file. To edit the editable text simply click on the shaded text and you can delete the existing text and replace it with your custom text. The shaded area will not print. The fonts are embedded and will not change.

How to score

Scoring is the act of creating a line or depression in the paper that will help the paper fold. As paper gets heavier it is increasingly harder to fold. It is therefore a good idea to score the paper before folding it and sometimes before cutting it. To score a line use a dull knife or embossing stylus and a ruler. Hold the ruler firmly at the place you want to fold. Then take the knife or stylus and draw a line, staying right next to the ruler. You want to press down firm enough to create a valley in the paper deep enough to allow the paper to fold easily.

Printing

- ❖ Experiment with your printer's print quality. You should get good results printing at Standard Quality. But you may want to print at the highest quality available for your printer.
- ❖ Set your Page Scaling to None in the Printer's dialog box. You may get an error message. Just ignore it.
- ❖ Since this pdf contains several pages, be sure to set your print options to print: Current page.
- ❖ If you are having trouble with parts of the design (not the instructions) not printing around the edges, it means your printer has wide margins. Just adjust the print setting to fit to paper. This is not recommended for cards.

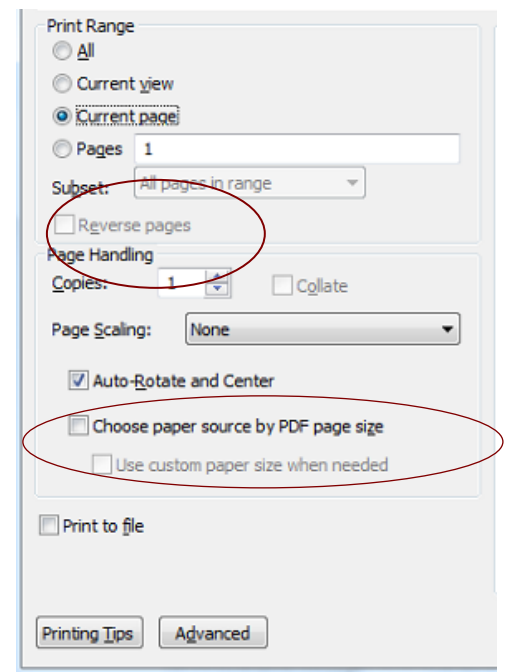

Contact

Please feel free to contact me at: www.partytimemysteries.com with any questions or concerns.

Cake Box

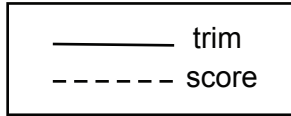

Instructions:

1. Type personal message in heart if desired. Print the page on cardstock. (Print 11 to make a full cake)
2. Score the box using the dashed score lines.
3. Cut out the outline of the box.
4. Cut the slit at the end of the box using an exacto knife or razor blade.
5. Glue or tape Tab A and Tab B to the inside of the box.
6. Tuck Tab C into the slit at the end of the box.

